



WHERE WE ARE

Child and Youth Outpatient Services offices are off-site from Oakville Hospital. We are located in the Oakville Corporate Centre, 6th Floor, 700 Dorval Drive (enter from Wycroft Road).

Program and office open from 8:30 am – 4:30 pm, Monday – Friday. Statutory holidays exempt. Services covered by Ministry of Health.

Telephone: 905 815 5140 Fax 905 815 5076

Free parking is available.

Staff will return calls during business hours.

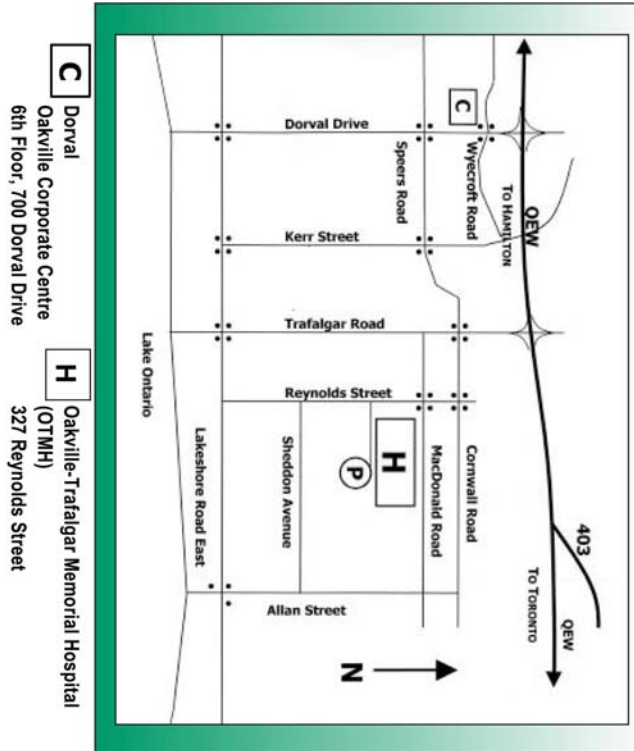

Halton Healthcare
Oakville-Trafalgar Memorial Hospital
Phone: (905) 845-2571
www.haltonhealthcare.com

Halton Healthcare is a multi-site healthcare organization providing the highest quality care possible, close to home. If you would like to help support the Mental Health/Social Services Program at HHS please call the Oakville Hospital Foundation at 905-338-4642, specifying that you wish to direct your donation to mental health. Donations will be used only to further quality client care. Visit our website at www.haltonhealthcare.com.

Child and Youth Mental Health Outpatient Services



Take on life.



Halton Healthcare

Take on life.

To assist children, adolescents and their families to achieve and maintain positive mental health in all aspects of their lives.

CHILD & YOUTH OUTPATIENT SERVICES

The Child & Youth Mental Health Outpatient Services consists of a community based, multidisciplinary team dedicated to the assessment and short-term treatment of children and adolescents who are experiencing mental health concerns.

The team includes a child and adolescent psychiatrist, a psychiatric nurse, a social worker and an intake worker.

ADMISSION CRITERIA

Residents of Oakville, Milton, Georgetown or Halton Hills who are between the ages of 0-17 with a potential mental health concern.



GOALS

1. To assess and provide follow-up treatment to children, adolescents and their families.
2. To provide psychopharmacological consultations to family physicians.
3. To promote and restore mental health in children and adolescents who are struggling with their moods, thoughts and/or behaviour.

SERVICES

We will liaise with schools and other agencies involved in the ongoing care. We may make referrals to other resources as is indicated.

REFERRAL SOURCES

Physicians affiliated with Halton Healthcare and/or physicians of clients living in Oakville, Milton, Georgetown or Halton Hills.

Child & Adolescent Psychiatric Inpatient Services and Crisis Services at Halton Healthcare.

